



4-IN-1™ Utility Clamping System

The most versatile Sliding Arm Clamps in the market.



Ergonomic Comfort Handle with purchase of G / M Rail clamps.

- UM Models:**
Plastic handle ONLY
- UG Models:**
Plastic Handle + Cap

Removable / Reversible Clamp Arm

Standard Pad



Replaceable Heavy Duty Pad

Self-aligning

Extender Block

V-Pad

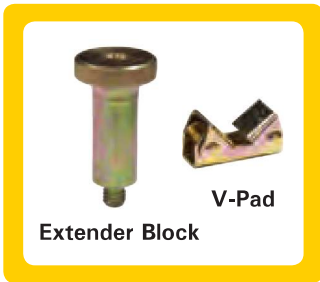

4-IN-1 ACCESSORY PACK

The 4-IN-1 Clamp Kit comes complete with the V-Pad and Extender Block accessories.

(See page 40 for details.)

Tapped Hole

For attaching accessories such as the V-Pad or Extender Block.

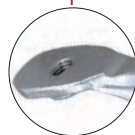

UE,UF,UG,UM Models:
Press the Spring Stop to slide the clamp arm ON & OFF



UD Models:
Remove the Key Ring.

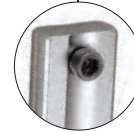

UP Models:
Remove the Screw Stop.

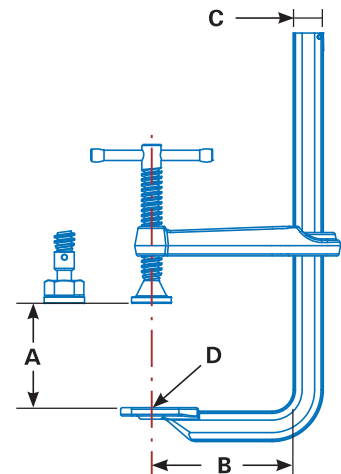

Optional Slide-on SIDEKICKS

Mount onto Clamps for the 2nd axis clamping.

(See page 40 for details.)

ONE Clamp... FOUR functions.

The strong, economical 4-IN-1 Utility Clamps adapt to serve four different applications.



1. Standard

Sliding Arm Clamps are 10x faster than a C-Clamp!



2. Pipe

Add the exclusive V-Pad to create a Pipe Clamp!

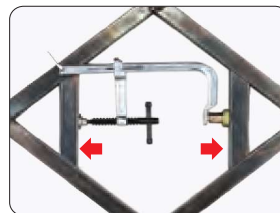

3. Spreader

Reverse the clamp arm and create a Spreader Clamp.



4. Step-Over

Add the Extender Block to create a Step-Over Clamp.

Ratchet Action & MagSpring™ Clamps

Quick-Set Clamps for fast, convenient clamping.

RATCHET ACTION UTILITY CLAMPS

Ratchet mechanism ensures rapid, vibration and torsion resistant clamping.

- Quick to setup, unlock, and remove in high volume clamping applications.
- Even clamping pressure. Ideal for repetitive clamping setups.

| Part No. | Capacity (mm) | Clamping Pressure (kg) | Rail Size (mm) | Weight (kg) |
|----------|---------------|------------------------|----------------|-------------|
| UF65RM | 165 | 400 | 22 x 11 | 1.2 |
| UF100RM | 255 | 400 | 22 x 11 | 1.3 |
| UF100JRM | 254 | 400 | 22 x 11 | 1.4 |
| UG85RM | 216 | 500 | 25 x 12 | 1.6 |
| UG125RM | 318 | 500 | 25 x 12 | 2.2 |
| UG205RM | 521 | 500 | 25 x 12 | 2.6 |



UF100JRM
Sturdy J-shaped 76 mm return for step-over applications.

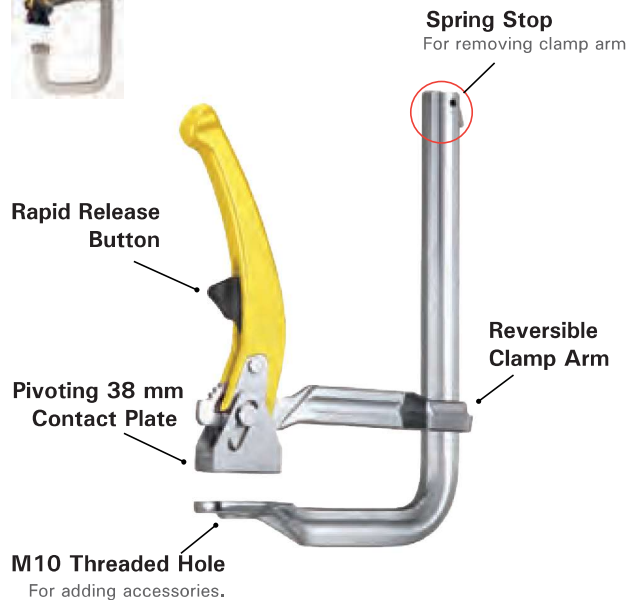

MAGSPRING™ CLAMPS

The spring-loaded, one-handed clamp with quick-set V-Pad.

The Spring Arm in conjunction with the V-Pad allows users to free up one hand to position the workpiece.

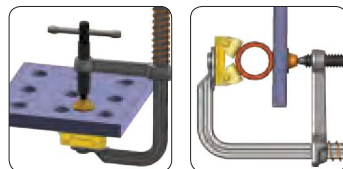

Spring Loaded Arm

The MagSpring™ holds onto metal, wood and synthetic materials.



Magnetic V-Pad

Instantly adjusts for different shapes: round, flat, and angle steel surfaces.

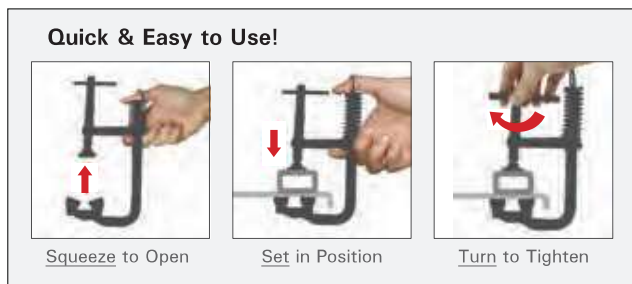
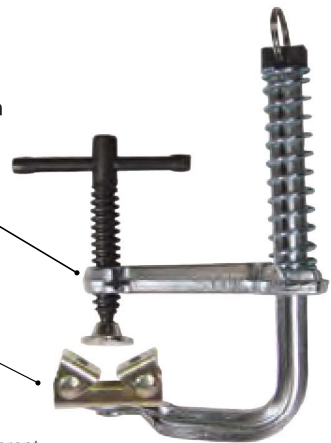

| Part No. | Capacity (mm) | Throat Depth (mm) | Clamping Pressure (kg) | Tapped Hole (mm) | Weight (mm) |
|----------|---------------|-------------------|------------------------|------------------|-------------|
| UBV65M | 115 | 63 | 140 | M6 | 0.4 |
| UDV45M | 75 | 83 | 230 | M8 | 0.5 |
| UDV65M | 115 | 83 | 230 | M8 | 0.7 |